

# Mounting Instructions

WITH SET-UP DATA

## SHOCK ABSORBER HD540 for Harley-Davidson FLHRS Road King

Before installing this shock absorber, check the contents of the kit listed below. If anything is missing, please contact your nearest Öhlins dealer.

### Kit Contents:

	Part no.	Pcs.
Shock absorber	HD540	1
C-spanner	00710-01	2
Sleeve	00123-13	4
Washer	03118-08	8
Screw	03128-02	2
Öhlins Sticker	00192-01	2
Owner's Manual	07241-02	1

During storage and transportation, especially at high ambient temperature, some of the oil and grease used for assembling may leak and stain the packaging. This is in no way detrimental to the product, wipe off the excessive oil/grease with a cloth.

### Set-up Data

Shock absorber length	296 mm
Stroke	71 mm
Spring preload	21 mm



Before installing this product, read the Öhlins Owner's Manual!



Öhlins Racing AB, Box 722, S-194 27 Upplands Väsby, Sweden.  
Phone +46 8 590 025 00 Fax +46 8 590 025 80  
[www.ohlins.com](http://www.ohlins.com)

© Öhlins Racing AB. All rights reserved. Any reprinting or unauthorized use without the written permission of Öhlins Racing AB is prohibited.  
Printed in Sweden.



Mounting Instructions HD540 Issued 2008 05 05  
These instructions and other documents can be downloaded from  
[www.ohlins.com](http://www.ohlins.com)

## HOW TO INSTALL

### ⚠ WARNING!

It is advisable to have an Öhlins dealer install the shock absorber.

1

Put the motorcycle on a workstand so that the rear wheel barely touches the ground.

### ⚠ WARNING!

Make sure the vehicle is securely supported so that it will not tip.

2

Loosen the upper and lower attachments of the original shock absorber.

### NOTE!

Recommendation! Before installing the Öhlins shock absorber, clean the vehicle thoroughly.

3

Install the Öhlins shock absorber in the same way as the original unit.

### NOTE!

Normally the shock absorber is installed with the cylinder head upwards. Make sure that there is enough clearance to other details both in loaded and unloaded position.

4

Lower the motorcycle so that the shock absorber is slightly compressed, before tightening the screws.

### NOTE!

Make sure that all screws are tightened to the correct torque and that nothing fouls or restricts movement of the shock absorber when the suspension is being fully compressed or extended.

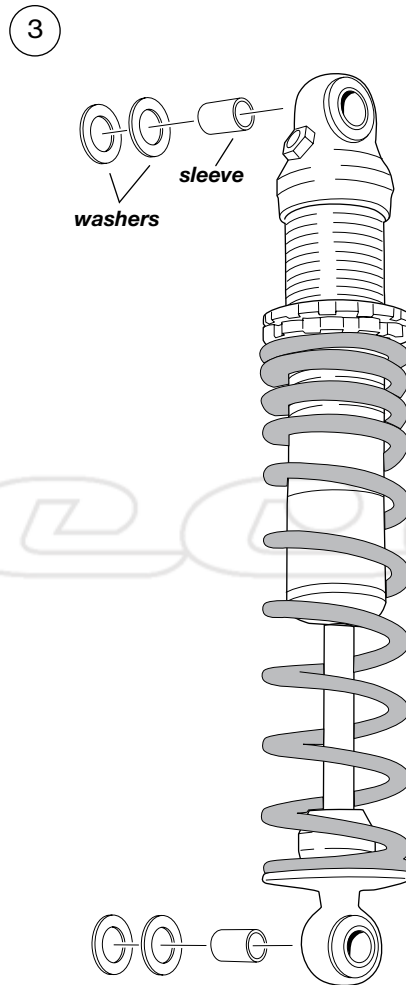

## ADJUSTMENTS

Before riding, always ensure that the basic settings made by Öhlins are intact.

- 1 Use a C-spanner. Unlock the lock nut (B). Turn the spring platform nut (A) clockwise to increase the spring pre-load, turn counter clockwise to decrease it. Lock the setting with the lock nut (B).

### NOTE!

When delivered the Öhlins shock absorber is dialed to the recommended setting for the specific brand and make of the vehicle.

