

## ADJUSTMENTS

Before riding, always ensure that the basic settings made by Öhlins are intact.

- 1 **Spring preload**  
Turn the Hydraulic Adjuster knob to set the spring preload. Turn clockwise to increase the preload, turn counter clockwise to decrease.
- 2 **Rebound**  
Turn the wheel on the piston shaft above the end eye/ bracket. Turn clockwise to increase damping, turn counter clockwise to decrease.
- 3 **Compression**  
Adjust by turning the knob on top of the reservoir. Turn clockwise to increase damping, turn counter clockwise to decrease.

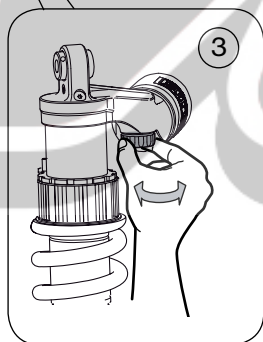
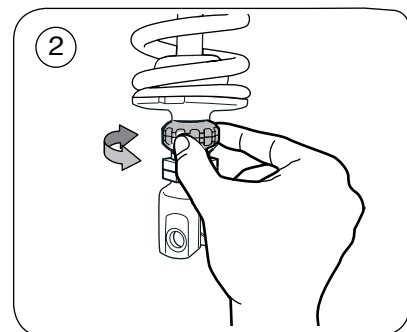
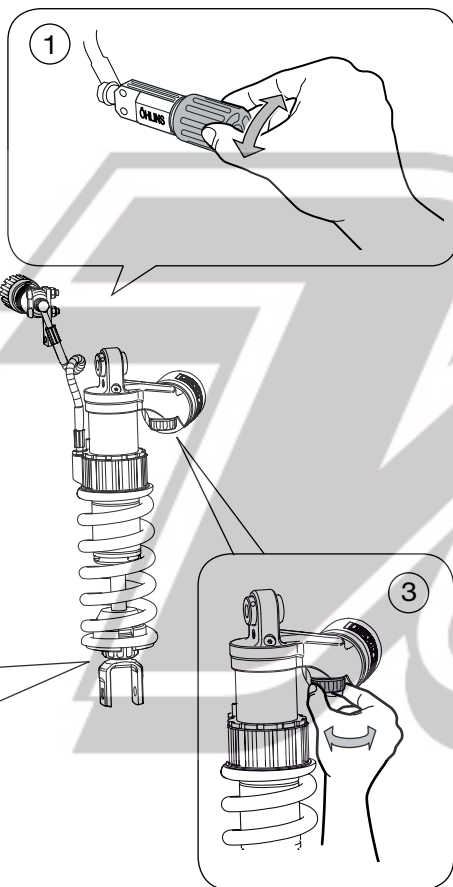

### NOTE!

When delivered the Öhlins shock absorber is dialed to recommended settings for the specific brand and make of the vehicle. If you have changed the setting, reset according to the set-up data in the Mounting Instruction.

To reset: The adjuster has a right hand thread. Turn the adjuster clockwise to fully closed (pos. zero [0]). Turn counter clockwise to open and count the clicks until you reach the recommended number in the Set-up data.

### CAUTION!

Do not use force, delicate sealing surfaces can be damaged. Handtighten only.

# Mounting Instructions

WITH SET-UP DATA

## SHOCK ABSORBER KA 709 for Kawasaki GTR 1400

Before installing this shock absorber, check the contents of the kit listed below. If anything is missing, please contact your nearest Öhlins dealer.

### Kit Contents:

	Part no.	Pcs.
Shock absorber	KA 709	1
Washer	00153-04	2
Tie wrap	00231-01	2
Nut M6	00430-02	1
Screw MC6S	01046-17	1
Öhlins Sticker	00192-01	2
Memo Notes Sticker	01180-01	1
Owner's Manual	07241-02	1

During storage and transportation, especially at high ambient temperature, some of the oil and grease used for assembling may leak and stain the packaging. This is in no way detrimental to the product, wipe off the excessive oil/grease with a cloth.

### Set-up Data

Shock absorber length	355.5 mm
Stroke	70.5 mm
Spring preload	12 mm
Compression damping	14 clicks

Rebound damping	14 clicks
Spring	01095-49
Free spring length	180 mm (130N/mm)

Before installing this product, read the Öhlins Owner's Manual!

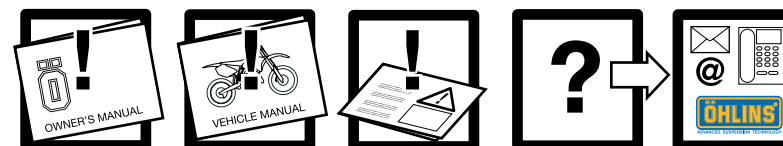

## HOW TO INSTALL

### ⚠ WARNING!

It is advisable to have an Öhlins dealer install the shock absorber.

**1**

Put the motorcycle on a workstand so that the rear wheel barely touches the ground.

### ⚠ WARNING!

Make sure the vehicle is securely supported so that it will not tip.

**2**

Remove the silencer.

**3**

Remove the passenger foot peg on the left side and loosen the original preload adjuster.

**4**

Remove the lower attachment of the original shock absorber.

**5**

Remove the upper attachment and remove the original shock absorber. Consult your Vehicle Service Manual.

### NOTE!

*Recommendation: Before installing the Öhlins shock absorber clean the vehicle thoroughly.*

**6**

Install the Öhlins shock absorber. Lead the preload adjuster through the swing arm on the left side and follow with the shock absorber from the right side. The reservoir should be pointing towards the front, and on the right side of the vehicle.

### NOTE!

*It may be necessary to adjust the preload adjuster to maximum while putting the shock absorber in place to get enough clearance for the spring in the swing arm. If you adjust it to maximum, make sure that you readjust it before riding.*

**7**

Install the attachment bolts, but do not tighten yet.

### NOTE!

*Lower the motorcycle so that the shock absorber is slightly compressed, before tightening the screws.*

**8**

Tighten the attachment and linkage bolts to the correct torque according to the Kawasaki specs.

**9**

Reinstall the silencer.

**10**

Fasten the hydraulic preload adjuster in the same position as the original unit, see figure. use the rear mounting hole, provided screw, nut and washers. use the tie wraps provided for the hose.

**11**

Reinstall the passenger foot peg.

*Make sure that all screws are tightened to the correct torque and that nothing fouls or restricts movement of the shock absorber when the suspension is fully compressed or extended.*

View from the left side of the vehicle.

